

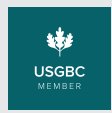

FABRICATED REBAR

DWR provide the most advanced equipment and technology to manufacture fabricated rebar with pinnacle precision to meet our customer's precise specifications. This combined with our highly experienced technical support, will undoubtedly help you reduce costs in materials, time, and labor.

WE ARE A PROUD MEMBER OF



BAR SIZE	NOMINAL DIMENSIONS		
	AREA (IN ²)	WEIGHT (LB/FT)	DIAMETER (IN)
#3 (#10)	0.11	0.376	0.375
#4 (#13)	0.20	0.668	0.500
#5 (#16)	0.31	1.043	0.625
#6 (#19)	0.44	1.502	0.750
#7 (#22)	0.60	2.044	0.875
#8 (#25)	0.79	2.670	1.000
#9 (#29)	1.00	3.400	1.128
#10 (#32)	1.27	4.303	1.270
#11 (#36)	1.56	5.313	1.410

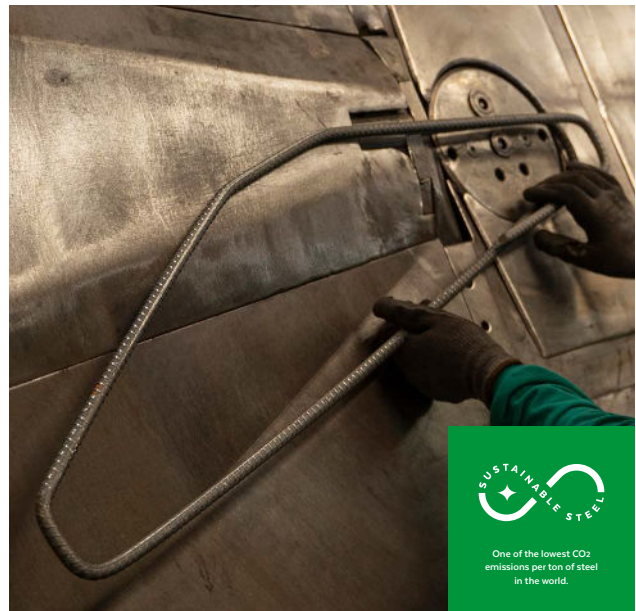

In accordance with ACI 318 Building Code.



dwreinforcing.com

BUILDING AND SECURING YOUR FUTURE

FABRICATED REBAR



DWR REBAR GRADES MEETS ASTM SPECIFICATIONS.

STEEL TYPE	BAR SIZE RANGE	GRADE	MIN. YIELD (KSI)	MIN. TENSILE (KSI)
CARBON A615	#3-#6	40	40	60
	#3-#11	60	60	90
	#3-#11	75	75	100
	#3-#11	80	80	105
	#3-#11	100	100	115
LOW-ALLOY A706	#3-#11	60	60	80
	#3-#11	80	80	100
STAINLESS	#3-#11	60	60	90
	#3-#11	75	75	100
RAIL & AXLE A706	#3-#8	40	40	70
	#3-#8	50	50	80
	#3-#11	60	60	90
LOW-CARBON	#3-#11	100	100	150
	#3-#11	120	120	150

RECOMMENDED END HOOKS DIMENSIONS

All grades of steel. D = Finished inside bend diameter (includes spring back)

BAR SIZE	D	180° HOOKS		90° HOOKS
		A OR G	J	A OR G
#3	2 1/4"	0'-5"	0'-3"	0'-6"
#4	3"	0'-6"	0'-4"	0'-8"
#5	3 3/4"	0'-7"	0'-5"	0'-10"
#6	4 1/2"	0'-8"	0'-6"	1'-0"
#7	5 1/4"	0'-10"	0'-7"	1'-2"
#8	6"	0'-11"	0'-8"	1'-4"
#9	9 1/2"	1'-3"	0'-11 3/4"	1'-7"
#10	10 3/4"	1'-5"	1'-1 1/4"	1'-10"
#11	12"	1'-7"	1'-2 3/4"	2'-0"

180° STANDARD HOOK

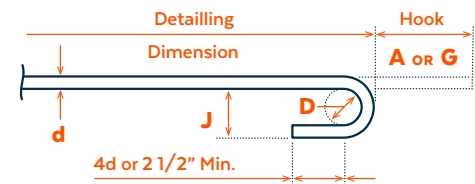

90° STANDARD HOOK

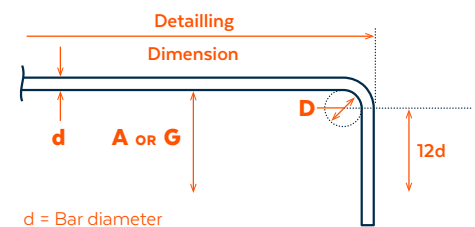

90° AND 135° STIRRUP & TIE HOOKS

All grades of steel.

BAR SIZE	D	90° HOOKS		135° HOOKS	
		A OR G	A OR G	H (APPROX.)	
#3	1 1/2"	0'-4"	4"	2 1/2"	
#4	2"	0'-4 1/2"	4 1/2"	3"	
#5	2 1/2"	0'-6"	5 1/2"	3 3/4"	
#6	4 1/2"	1'-0"	8"	4 1/2"	
#7	5 1/4"	1'-2"	9"	5 1/4"	
#8	6"	1'-4"	10 1/2"	6"	

90° STIRRUP & TIE HOOK

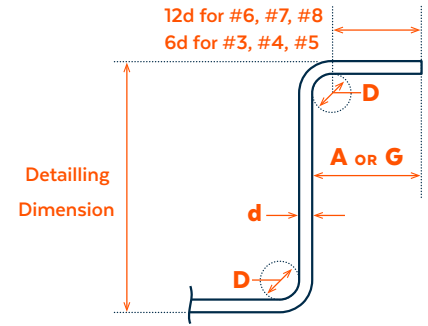

135° STIRRUP & TIE HOOK

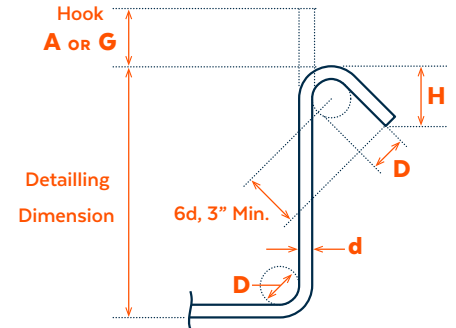

180° STIRRUP & TIE HOOKS

All grades of steel.

BAR SIZE	D	180° HOOKS		
		A OR G	J	HOOK LENGTH
#3	1 1/2"	4"	2 1/4"	3 3/4"
#4	2"	5"	3"	4"
#5	2 1/2"	6"	3 3/4"	4 1/2"
#6	4 1/2"	8"	6"	6"
#7	5 1/4"	10"	7"	7"
#8	6"	11"	8"	8"

180° STIRRUP & TIE HOOK

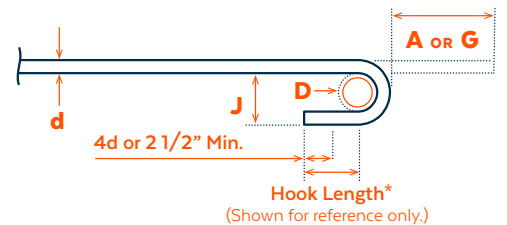

135° SEISMIC STIRRUP & TIE HOOKS

All grades of steel.

BAR SIZE	D	135° HOOKS	
		A OR G	H (APPROX.)
#3	1 1/2"	4 1/4"	3"
#4	2"	4 1/2"	3"
#5	2 1/2"	5 1/2"	3 3/4"
#6	4 1/2"	8"	4 1/2"
#7	5 1/4"	9"	5 1/4"
#8	6"	10 1/2"	6"

135° SEISMIC HOOK

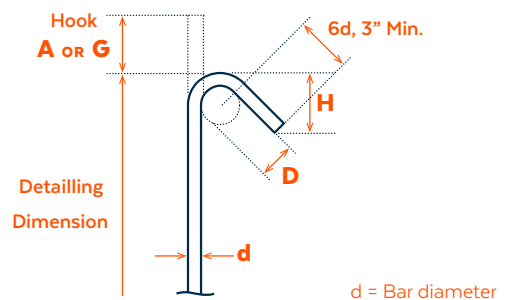

STIRRUP



STIRRUP



CLOSED



OPEN



CIRCLE



TRIANGLE

SKU	UNIT	DESCRIPTION	BAR #	aSa BEND	PIECES P/BUNDLE	PIECES P/UNIT	BUNDLES P/UNIT	LBS P/UNIT
ITKOAMB	PALLET	#3 STIRRUP 6" X 18"	3	S9	30	1500	50	2,343.00
ITKOAMA	PALLET	#3 STIRRUP 6" X 24"	3	S9	30	1200	40	2,326.00
CB01406	PALLET	#3 STIRRUP 6" X 6"	3	T2	25	2000	80	2,008.00
CB01407	PALLET	#3 STIRRUP 6" X 12"	3	T2	25	1000	40	1,380.00
CB01408	PALLET	#3 STIRRUP 6" X 18"	3	T2	25	1250	50	2,195.00
CB01409	PALLET	#3 STIRRUP 6" X 24"	3	T2	25	1000	40	2,123.00
CB01410	PALLET	#3 STIRRUP 8" X 18"	3	T2	25	1000	40	1,880.00
CB01411	PALLET	#3 STIRRUP 8" X 24"	3	T2	25	1000	40	2,256.00
ITKOARH	PALLET	#3 STIRRUP 10" X 18"	3	T2	25	1000	40	2,007.00
ITKOARJ	PALLET	#3 TRIANGLE STIRRUP 6"X 6"X6"	3	T13	25	1000	40	815.00
CB01430	PALLET	#3 X 18 X 6 CLOSED	3	T2	25	500	20	878.00
CB01431	PALLET	#3 X 18 X 7 CLOSED	3	T2	25	500	20	908.00
CB01432	PALLET	#3 X 18 X 8 CLOSED	3	T2	25	500	20	940.00
CB01433	PALLET	#3 X 24 X 8 CLOSED	3	T2	25	500	20	1,128.00
CB01434	PALLET	#3 X 30 X 8 CLOSED	3	T2	25	500	20	1,316.00
CB01435	PALLET	#3 X 17 X 6 OPEN	3	S3	25	500	20	752.00
CB01436	PALLET	#3 X 18 X 6 OPEN	3	S3	25	500	20	748.00
CB01437	PALLET	#3 X 24 X 6 OPEN	3	S3	25	500	20	972.00
CB01438	PALLET	#3 X 30 X 6 OPEN	3	S3	25	500	20	1,160.00
CB01439	PALLET	#3 X 18 X 7 OPEN	3	S3	25	500	20	799.00
CB01440	PALLET	#3 X 24 X 7 OPEN	3	S3	25	500	20	987.00
ITK00UL	PALLET	#3 STIRRUP 6" X 12"	3	S9	10	500	50	626.00
ITK00UM	PALLET	#3 STIRRUP 6" X 18"	3	S9	10	500	50	814.00
ITK00UN	PALLET	#3 STIRRUP 6" X 19"	3	S9	10	500	50	846.00
ITK00UO	PALLET	#3 STIRRUP 6" X 21"	3	S9	10	500	50	908.00
ITK00UP	PALLET	#3 STIRRUP 6" X 23"	3	S9	10	500	50	972.00
ITK00UQ	PALLET	#3 STIRRUP 6" X 25"	3	S9	10	500	50	1,034.00
ITK00UR	PALLET	#3 STIRRUP 6" X 31"	3	S9	10	500	50	1,222.00
ITK00US	PALLET	#3 STIRRUP 6" X 35"	3	S9	10	500	50	1,348.00
ITK00UT	PALLET	#3 STIRRUP 6" X 37"	3	S9	10	500	50	1,410.00
ITK00UU	PALLET	#3 STIRRUP 6" X 41"	3	S9	10	500	50	1,536.00
ITK00UV	PALLET	#3 STIRRUP 6" X 43"	3	S9	10	500	50	1,598.00
ITK00UW	PALLET	#3 STIRRUP 6" X 45"	3	S9	10	500	50	1,660.00
ITK00UX	PALLET	#3 STIRRUP 6" X 47"	3	S9	10	500	50	1,724.00
ITK00UY	PALLET	#3 STIRRUP 6" X 49"	3	S9	10	500	50	1,786.00
ITK00XW	PALLET	#3 STIRRUP 6" X 12"	3	T2	200	1600	8	2,208.00
ITK00XX	PALLET	#3 STIRRUP 6" X 18"	3	T2	200	1200	6	2,107.00
ITK00XY	PALLET	#3 STIRRUP 6" X 24"	3	T2	200	1000	5	2,132.00
ITK00XZ	PALLET	#3 STIRRUP 6" X 30"	3	T2	200	800	4	2,006.00
ITK00Y0	PALLET	#3 STIRRUP 8" X 18"	3	T2	200	1200	6	2,256.00
ITK00Y1	PALLET	#3 STIRRUP 8" X 24"	3	T2	200	1000	5	2,256.00
ITK00Y2	PALLET	#3 CIRCLE 6" - (6" OVERLAP)	3	T3	200	2800	14	2,190.00
ITK00Y3	PALLET	#3 CIRCLE 12" - (6" OVERLAP)	3	T3	200	1600	8	2,208.00
ITK00Y4	PALLET	#3 CIRCLE 18" - (6" OVERLAP)	3	T3	200	1000	5	1,944.00
ITK01V2	PALLET	#3 CIRCLE 1' 6" - (12" OVERLAP)	3	T3	50	600	12	2,228.00

L BAR

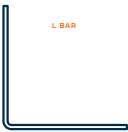

L BAR

SKU	UNIT	DESCRIPTION	BAR #	aSa BEND	PIECES P/BUNDLE	PIECES P/UNIT	BUNDLES P/UNIT	LBS P/UNIT
CB01441	PALLET	L BAR 5/8 - 24" X 24"	5	17	10	500	50	2,086.00
ITK00XU	PALLET	L BAR 1/2 - 18" X 18"	4	S10	10	1000	100	2,004.00
ITK00XV	PALLET	L BAR 5/8 - 24" X 24"	5	S10	50	500	10	2,086.00
ITK22ZT	PALLET	L BAR 1/2 - 12" X 36"	4	17	25	825	33	2,204.40

U BAR



U BAR

SKU	UNIT	DESCRIPTION	BAR #	aSa BEND	PIECES P/BUNDLE	PIECES P/UNIT	BUNDLES P/UNIT	LBS P/UNIT
ITKOARM	PALLET	U BAR 6" X 12" X 6"	4	2	25	1000	40	1,336.00
ITK00XT	BAG	U BAR 1/2 - 6" X 12" X 6"	4	S10		2000		2,672.00

REBAR PIN

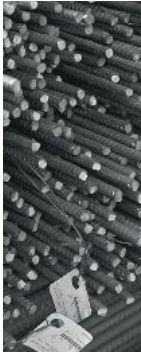

SKU	UNIT	DESCRIPTION	BAR #	aSa BEND	PIECES P/BUNDLE	PIECES P/UNIT	BUNDLES P/UNIT	LBS P/UNIT
CBB3L01	PALLET	REBAR PIN 3/8 - 1FT	3	STRAIGHT	100	6600	66	2,481.60
CBB3L02	PALLET	REBAR PIN 3/8 - 2FT	3	STRAIGHT	50	3200	64	2,406.40
CBB3L03	PALLET	REBAR PIN 3/8 - 3FT	3	STRAIGHT	50	2200	44	2,481.60
CBB3L04	PALLET	REBAR PIN 3/8 - 4FT	3	STRAIGHT	25	1650	66	2,481.60
CBB3L10	BUNDLE	REBAR PIN 3/8 - 10FT	3	STRAIGHT	266	266	1	1,000.16
CBB4L01	PALLET	REBAR PIN 4/8 - 1FT	4	STRAIGHT	50	3700	74	2,471.60
CBB4L02	PALLET	REBAR PIN 4/8 - 2FT	4	STRAIGHT	25	1800	72	2,404.80
CBB4L03	PALLET	REBAR PIN 4/8 - 3FT	4	STRAIGHT	25	1250	50	2,505.00
CBB4L04	PALLET	REBAR PIN 4/8 - 4FT	4	STRAIGHT	25	925	37	2,471.60
CBB4L10	BUNDLE	REBAR PIN 4/8 - 10FT	4	STRAIGHT	150	150	1	1,002.00
CBB5L10	BUNDLE	REBAR PIN 5/8 - 10FT	5	STRAIGHT	96	96	1	1,001.28
ITK01KZ	BUNDLE	REBAR PIN 3"8"	3	STRAIGHT	266	266	1	367.00
ITK01KO	BUNDLE	REBAR PIN 4"-8"	3	STRAIGHT	266	266	1	467.00
ITK01K1	BUNDLE	REBAR PIN 7"-8"	3	STRAIGHT	266	266	1	767.00
ITK06TC	BUNDLE	REBAR PIN 4/8" - 7'-9"	4	STRAIGHT	100	100	1	518.00
ITK06TD	BUNDLE	REBAR PIN 4/8" - 8'-9"	4	STRAIGHT	100	100	1	584.00
ITK01K2	BUNDLE	REBAR PIN 9'-9"	3	STRAIGHT	266	266	1	976.00

DOWEL



SKU	UNIT	DESCRIPTION	BAR #	aSa BEND	PIECES P/BUNDLE	PIECES P/UNIT	BUNDLES P/UNIT	LBS P/UNIT
ITK01EI	PALLET	3/8" X 18" ROUND DOWEL A36	3	SMOOTH/STRAIGHT	50	4000	80	2,256.00
ITK22HY	PALLET	1/2" X 10" ROUND DOWEL G60	4	SMOOTH/STRAIGHT	50	3900	78	2,171.00
ITK22RW	PALLET	1/2" X 18" ROUND DOWELS G60	4	SMOOTH/STRAIGHT	25	2000	80	2,004.00
ITK22RX	PALLET	1/2" X 24" ROUND DOWEL G60	4	SMOOTH/STRAIGHT	25	2000	80	2,672.00
ITK01FM	PALLET	1/2" X 18" ROUND DOWEL G60	4	SMOOTH/STRAIGHT	50	2200	44	2,204.19
ITK01FN	PALLET	1/2" X 24" ROUND DOWEL G60	4	SMOOTH/STRAIGHT	50	1650	33	2,204.19
ITK01FO	PALLET	3/4" X 18" ROUND DOWEL G60	6	SMOOTH/STRAIGHT	50	1000	20	2,252.78
ITKEABK	PALLET	3/4" X 24" ROUND DOWEL G60	6	SMOOTH/STRAIGHT	25	1000	40	3,004.00
ITK01FP	PALLET	1" X 18" ROUND DOWEL G60	8	SMOOTH/STRAIGHT	50	550	11	2,202.53
ITK01FQ	PALLET	1-1/4" X 18" ROUND DOWEL G60	10	SMOOTH/STRAIGHT	50	350	7	2,259.00

WE SERVE THE CONSTRUCTION MARKET WITH A BROAD MIX OF SUPERIOR PRODUCTS AND STEEL SOLUTIONS.



1 800 867 6245 | mcswusa.com

Fabricated Rebar (Cut Bar & Bent Bar) | Wire Stucco Netting (17 ga & 20 ga) | PC Strand Gabions | Fabricated Bars & Beams (Cut & Punched in Bright, Galvanized, or Primed) Grade 40 & Grade 60 Rebar | Beam & Channels | Black Annealed Wire | Tie Wire (3.5 lb) Angle, Flat & Round Bars | Welded Wire Reinforcement Mesh | Silt Fence Wire Backing Fencing Solutions (Chain Link Fence, Ornamental Fence & Woven Fences) | Steel Fibers Wire Coil Nails, MQB Nails, Plastic Strip Nails, Paper Tape Nails & Staples | Cut Dowels Duplex Nails, Common Nails, Vinyl Sinkers, Masonry Nails & Spikes | Galvanized Welded